

Hylsor för kronmuttrar

Castellated sockets

Kraftsteckschlüssel für Kronmuttern

1" □

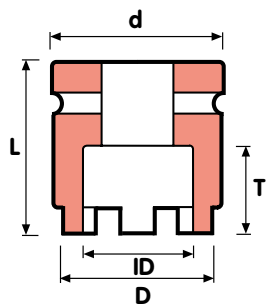

Part No	D mm	d mm	L mm	t mm	T mm	kg
1 1/2 9-C1 1/2	59,5	36	54	65	35	0,80
1 3/4 9-C1 3/4	69,5	42	54	65	35	1,00
2 9-C2	79	48	62	65	35	1,35
2 1/4 9-C2 1/4	89	58	62	65	35	1,50
2 1/2 9-C2 1/2	99	64,5	62	65	35	1,70
2 3/4 9-C2 3/4	108	71	76	71	40	2,40
3 9-C3	121	77	76	77	46	3,20
3 1/2 9-C3 1/2	140	90	76	91	60	4,80
4 9-C4	159	103	76	91	60	5,60
4 1/2 9-C4 1/2	178	116	76	102	70	8,70

1 1/2" □

Part No	D mm	d mm	L mm	t mm	T mm	kg
1 1/2 5-C1 1/2	59,5	36	84	80	39	2,00
1 3/4 5-C1 3/4	69,5	42	84	80	39	2,20
2 5-C2	79	48	84	80	39	2,30
2 1/4 5-C2 1/4	89	58	86	80	35	2,30
2 1/2 5-C2 1/2	99	64,5	86	80	35	2,50
2 3/4 5-C2 3/4	108	71	86	83	38	3,00
3 5-C3	121	77	86	88	43	3,90
3 1/2 5-C3 1/2	140	90	102	100	55	6,20
4 5-C4	159	103	102	100	55	7,40
4 1/2 5-C4 1/2	178	116	102	108	63	9,40
5 5-C5	194	128	102	108	63	10,50
5 1/2 5-C5 1/2	221	141	102	110	65	13,60

2 1/2" □



Part No	D mm	d mm	L mm	t mm	T mm	kg
2 6-C2	79	48	137	90	38	6,20
2 1/4 6-C2 1/4	89	58	137	98	38	6,30
2 1/2 6-C2 1/2	99	64,5	137	98	38	6,50
2 3/4 6-C2 3/4	108	71	137	98	38	6,60
3 6-C3	121	77	137	100	40	6,90
3 1/2 6-C3 1/2	140	90	137	105	45	7,18
4 6-C4	159	103	137	115	55	8,90
4 1/2 6-C4 1/2	178	116	160	120	60	12,80
5 6-C5	194	128	160	130	70	14,70
5 1/2 6-C5 1/2	221	141	160	135	75	18,30
6 6-C6	235	154	160	140	70	22,10
6 1/2 6-C6 1/2	252	167	160	145	75	25,40
7 6-C7	270	181	160	150	80	29,30

3 1/2" □

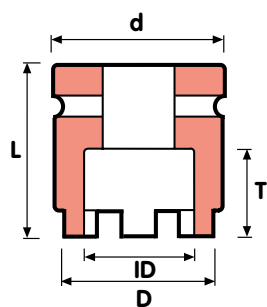

	Part No	D mm	d mm	L mm	t mm	T mm	kg
3 1/2	12-C3 1/2	140	90	195	145	60	20,20
4	12-C4	159	103	195	145	60	20,40
4 1/2	12-C4 1/2	178	116	195	150	65	20,90
5	12-C5	194	128	195	150	65	20,70
5 1/2	12-C5 1/2	221	141	195	175	65	28,10
6	12-C6	235	154	195	180	70	30,30
6 1/2	12-C6 1/2	252	167	195	185	75	34,10
7	12-C7	270	181	195	190	80	38,30

